

# WENTWORTH

ADDRESS	6950 S Sangamon St
PIN(S)	20-20-420-007 20-20-420-008 20-20-420-009
BUILDING SF	122,400
LAND SF	124,537
INCLUDES ANNEX/ BRANCH	Yes, pre 1930s
OWNERSHIP	PBC
ALDERMAN	R. Sawyer
WARD	6
NEIGHBORHOOD	Englewood
ZONING	RT4 surrounded by residential
MAINTENANCE COSTS (as school)	\$364,400
CARRY COSTS (vacant)	\$102,567

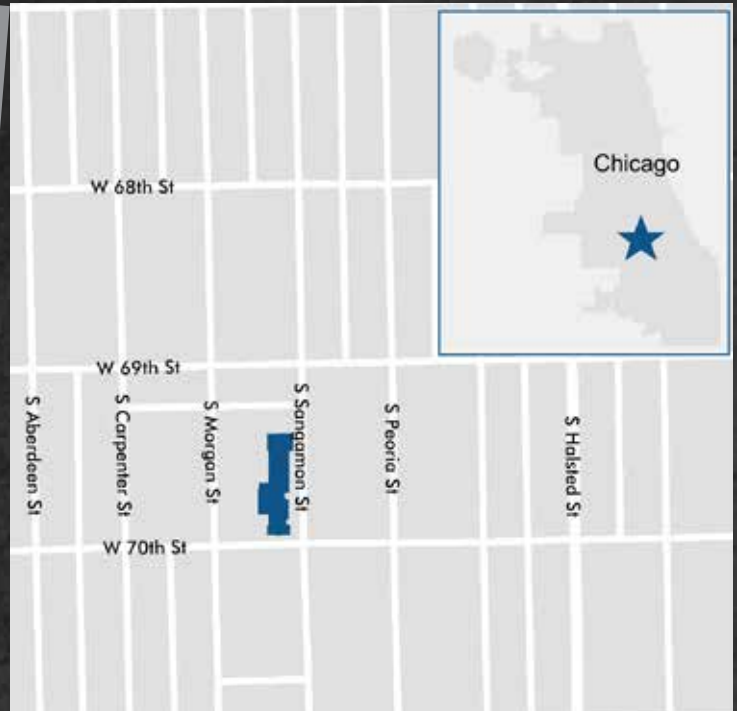

## TIF INFORMATION

TIF District	TIF Balance thru 2017	TIF Expiration	Adjacent TIF	Adjacent TIF Balances thru 2017
None	None	None	None	None



# WENTWORTH

## ADDITIONAL NOTES

EXISTING PLAN:	Not Applicable
PARK EXPANSION POTENTIAL	Not Applicable
CAMPUS PARK GROUND ISSUES	Not Applicable
PUBLIC ART	31 Progressive Era and 3 WPA/FAP murals. All restored.
HISTORIC PRESERVATION	May meet criteria for designation and/or National Register listing. Building is in a challenged neighborhood (Englewood) where reuse can have a positive impact.

## TYPICAL FLOORPLAN MAIN - 1ST FLOOR

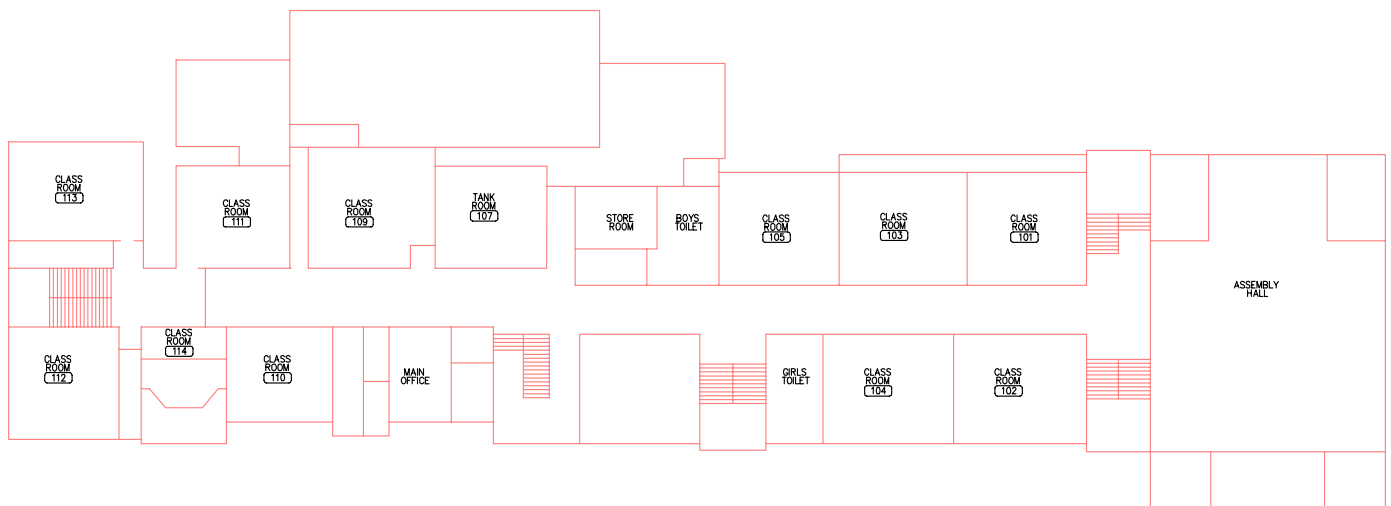

	CHICAGO PUBLIC SCHOOLS CAPITAL IMPROVEMENT PROGRAM ADMIN CONNECTIVITY PHASE
DANIEL WENTWORTH ELEMENTARY SCHOOL	UNIT NO: 6390
FIRST FLOOR PLAN	

DESIGNED BY	DFM	PROJECT NUMBER	98088-69	SCALE	AS NOTED	DATE	03-01-99	SHEET NO.	E1.1.1
DRAWN BY	DFM	APPROVED BY	CD						
CHECKED BY	DFM	McDonough Associates Inc. Engineers/Architects							
DATE									
NO. DATE	REVISION								