

ROSS

MAIN ADDRESS	6059 S Wabash Ave
PIN(S)	20-15-307-009 20-15-307-010 20-15-307-022 20-15-307-023
OWNERSHIP	PBC
BUILDING SF	64,200
LAND SF	88,606
INCLUDES ANNEX/ BRANCH	Yes, post war addition
CPC ADDRESS	30 E 61st St
PIN(S)	20-15-306-038
OWNERSHIP	City-owned
BUILDING SF	15,000
LAND SF	45,800
VACANT LAND ADDRESS	67-73 E 60th St
PIN(S)	20-15-307-011
OWNERSHIP	BOE
LAND SF	16,038
VACANT LAND ADDRESS	6016 S Michigan Ave
PIN(S)	20-15-307-012
OWNERSHIP	BOE
LAND SF	7,938
VACANT LAND ADDRESS	6001 S Wabash Ave
PIN(S)	20-15-307-001
OWNERSHIP	BOE
LAND SF	9,720
VACANT LAND ADDRESS	6009 S Wabash Ave
PIN(S)	20-15-307-002
OWNERSHIP	City-owned
LAND SF	6,318
OWNERSHIP	PBC and BOE
ALDERMAN	W. Cochran
WARD	20
NEIGHBORHOOD	Washington Park
ZONING	RT4 mixed-use & business
MAINTENANCE COSTS (as school)	\$285,200
CARRY COSTS (vacant)	\$114,091

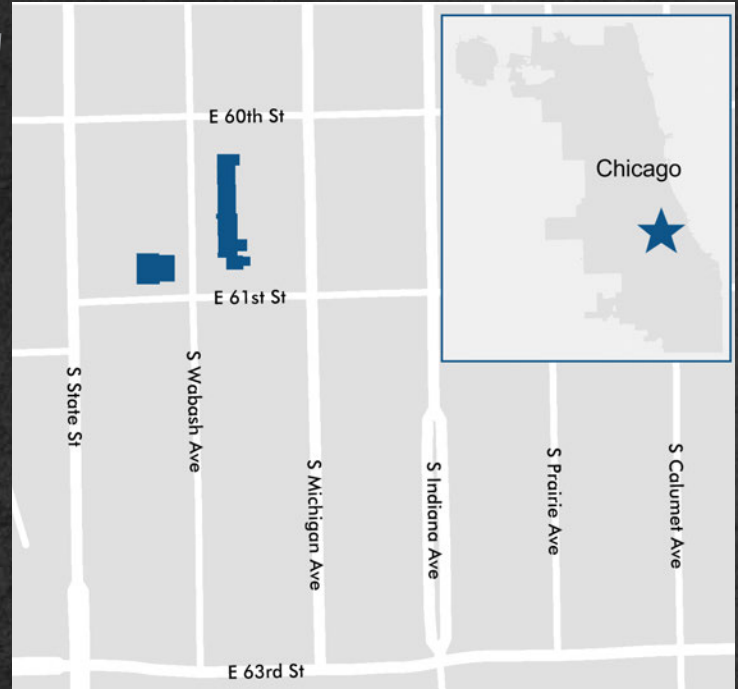

ROSS

TIF INFORMATION

TIF District	TIF Balance thru 2017	TIF Expiration	Adjacent TIF	Adjacent TIF Balances thru 2017
None	None	None	None	None

ADDITIONAL NOTES

EXISTING PLAN:	Not Applicable
PARK EXPANSION POTENTIAL	Not Applicable
CAMPUS PARK GROUND ISSUES	Campus park and city land
PUBLIC ART	Not Applicable
HISTORIC PRESERVATION	Building is not a priority for historic preservation. Relatively plain design from the post war period. Lorraine Hansberry attended this school. Lucy Flower Tech High School was on this site.

TYPICAL FLOORPLAN MAIN - 1ST FLOOR

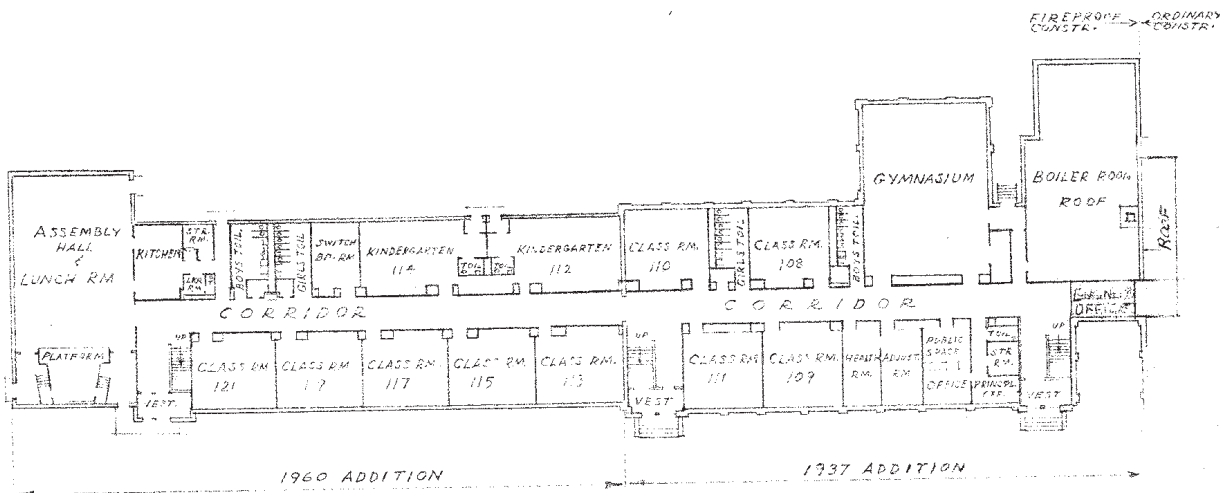

FIRST FLOOR PLAN
SCALE 1"=50'-0"

BETSY ROSS
ELEMENTARY SCHOOL
6059 SO. WABASH AVE.