

GOLDBLATT

MAIN BLDG & ANNEX ADDRESS	4257 W Adams St
PIN(S)	16-15-213-036
BUILDING SF	32,400
LAND SF	78,394
INCLUDES ANNEX/ BRANCH	Yes, post war. Connected to main building.
VACANT LAND ADDRESS	4258 W Adams St
PIN(S)	16-15-209-024
BUILDING SF	29,900
LAND SF	9,225
OWNERSHIP	PBC
ALDERMAN	J. Ervin
WARD	28
NEIGHBORHOOD	West Garfield Park
ZONING	RT4 surrounded by residential
MAINTENANCE COSTS (as school)	\$254,217
CARRY COSTS (vacant)	\$79,655



TIF INFORMATION

TIF District	TIF Balance thru 2017	TIF Expiration	Adjacent TIF	Adjacent TIF Balances thru 2017
None	None	None	None	None





GOLDBLATT

ADDITIONAL NOTES

EXISTING PLAN:	Not Applicable
PARK EXPANSION POTENTIAL	Not Applicable
CAMPUS PARK GROUND ISSUES	Not Applicable
PUBLIC ART	Not Applicable
HISTORIC PRESERVATION	Building is not a priority for historic preservation. Relatively plain design from the post war period. Not built by CPS.

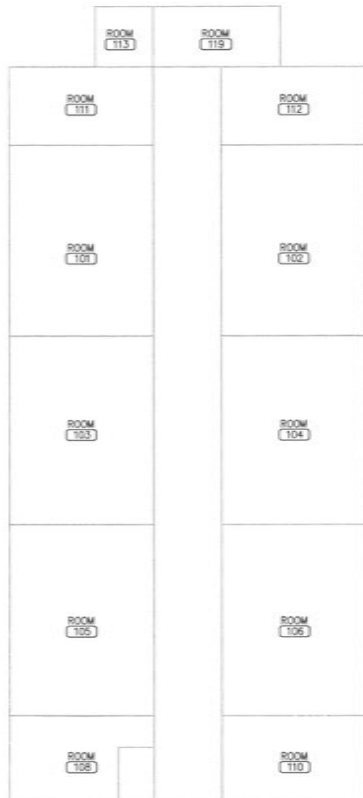
TYPICAL FLOORPLAN MAIN - 1ST FLOOR



	CHICAGO PUBLIC SCHOOLS CAPITAL IMPROVEMENT PROGRAM ADMIN CONNECTIVITY PHASE	
	NATHAN GOLDBLATT MAGNET SCHOOL	UNIT NO: 7840
FIRST FLOOR PLAN		