

# FISKE

<b>ADDRESS</b>	6145 S Ingleside Ave
<b>PIN(S)</b>	20-14-309-002 20-14-309-009
<b>BUILDING SF</b>	70,500
<b>LAND SF</b>	102,046
<b>INCLUDES ANNEX/ BRANCH</b>	No
<b>OWNERSHIP</b>	PBC
<b>ALDERMAN</b>	W. Cochran
<b>WARD</b>	20
<b>NEIGHBORHOOD</b>	Woodlawn
<b>ZONING</b>	RM5 surrounded by residential
<b>MAINTENANCE COSTS (as school)</b>	\$269,250
<b>CARRY COSTS (vacant)</b>	\$83,867

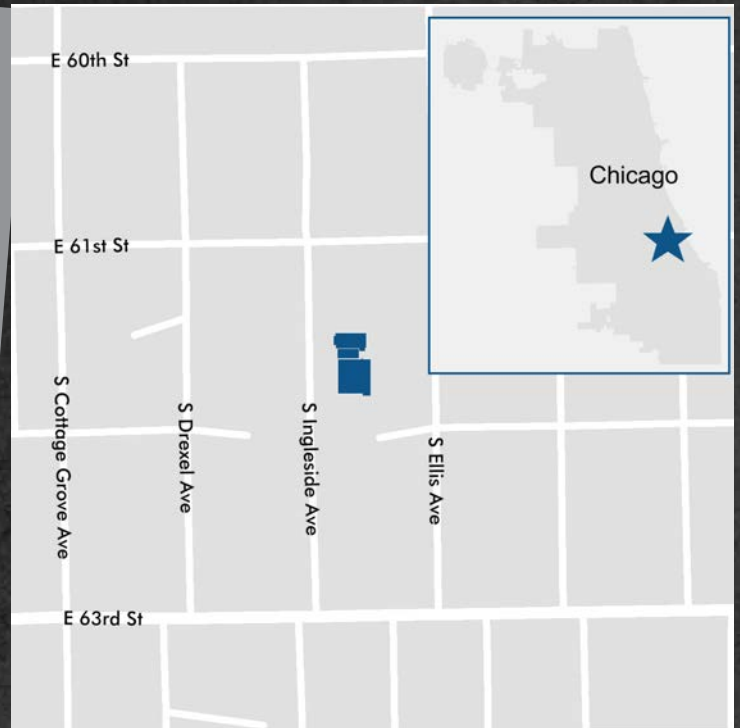

## TIF INFORMATION

TIF District	TIF Balance thru 2017	TIF Expiration	Adjacent TIF	Adjacent TIF Balances thru 2017
Woodlawn	\$4,300,548	1/20/2022	1) 71st/Stony Island 2) West Woodlawn	1) \$2,575,186 2) \$65,829



## ADDITIONAL NOTES

<b>EXISTING PLAN:</b>	Not Applicable
<b>PARK EXPANSION POTENTIAL</b>	Not Applicable
<b>CAMPUS PARK GROUND ISSUES</b>	Not Applicable
<b>PUBLIC ART</b>	Not Applicable
<b>HISTORIC PRESERVATION</b>	May meet criteria for designation and/or National Register listing. Building is in a challenged neighborhood (Woodlawn) where reuse can have a positive impact.

## TYPICAL FLOORPLAN MAIN - 1ST FLOOR

WARNING: ASBESTOS AND LEAD CONTAMINATION MAY BE PRESENT IN THE BUILDING. ASBESTOS MANAGEMENT PLAN IS AVAILABLE AT THE SCHOOL FOR REVIEW UPON REQUEST. LEAD PERFORMANCE REPORTS ARE AVAILABLE AT THE SCHOOL FOR REVIEW UPON REQUEST. A DETAILED ASBESTOS REPORT IS AVAILABLE UPON REQUEST. ALL WORK SHALL BE ACCORDING TO THE SPECIFICATIONS CONTAINED IN THE PROJECT DOCUMENTS AND IN COMPLIANCE WITH ALL LOCAL, STATE AND FEDERAL REGULATIONS AND STANDARDS.

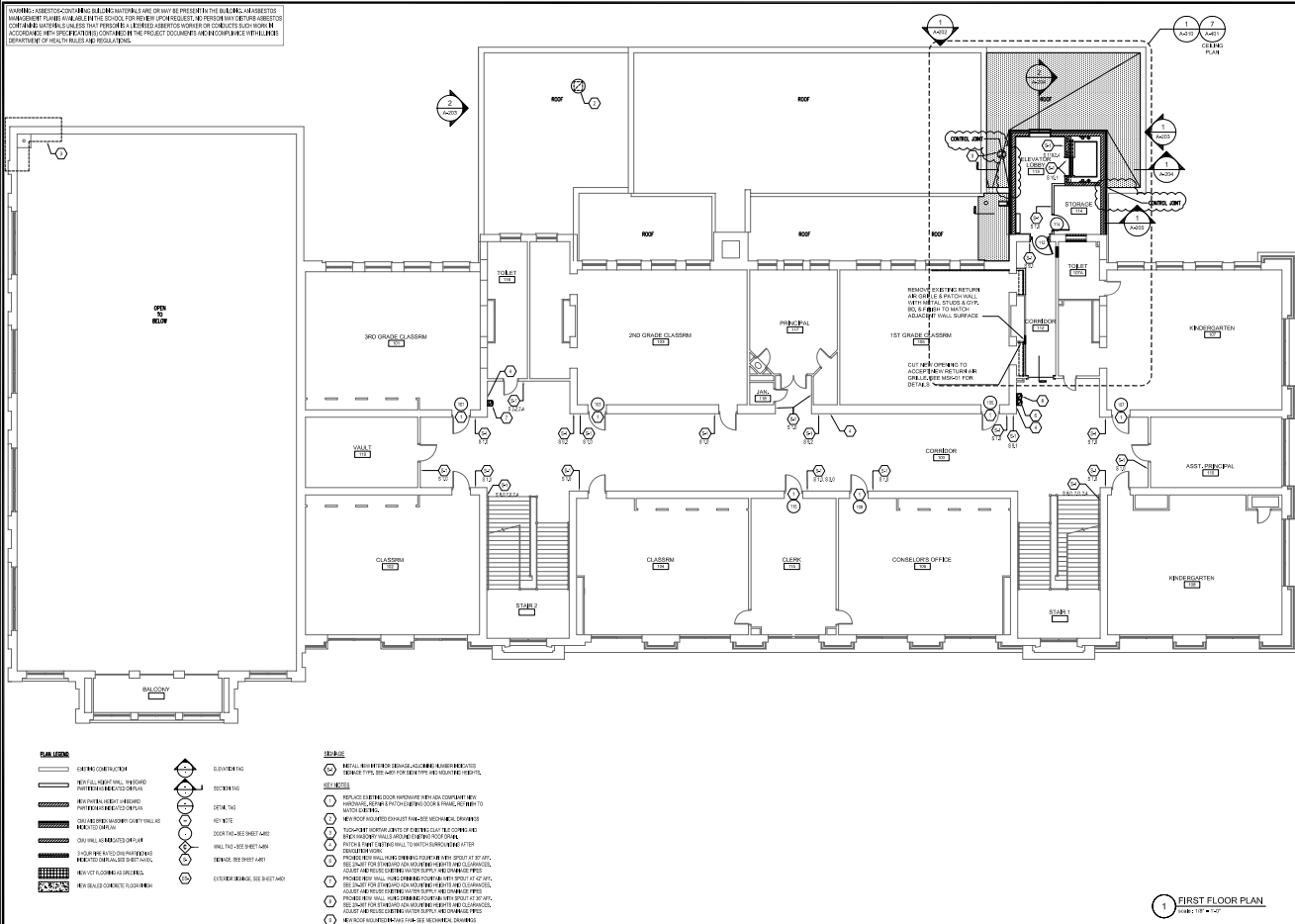

**CHICAGO PUBLIC SCHOOLS** CPS

**DEPARTMENT OF FACILITIES**  
CAPITAL IMPROVEMENT PROGRAM

**ARCHITECT OF RECORD:**  
BURNS, MIELT & HILL, LLC  
50 WEST WENDELL STREET, SUITE 1915  
CHICAGO, ILLINOIS 60607  
312.447.3100

**MEP ENGINEER:**  
BLANKS SYSTEMS ENGINEERING  
100 W. MADISON, SUITE 600  
CHICAGO, IL 60601  
312.544.7100

**STRUCTURAL ENGINEER:**  
AMMANN & WOODBURY LTD.  
150 WEST MADISON BUILDING, SUITE 1700  
CHICAGO, ILLINOIS 60604  
312.663.0200

**ENVIRONMENTAL ENGINEER:**  
WATCO ENGINEERING & CONSULTING, INC.  
8740 W. ROSSINGTON ROAD, SUITE 200  
CHICAGO, ILLINOIS 60618  
773.693.8000

REVISION DATE: JANUARY 15, 2011

**CPS - JOHN FISKE**  
ELEMENTARY  
6145 SOUTH WOODLAWN AVENUE  
CHICAGO, ILLINOIS 60637  
PROJECT NO. 2009-1300-40A

NO.	DATE	DESCRIPTION
1	01/15/11	ISSUED FOR PERMITS
2	01/15/11	ISSUED FOR PERMITS
3	01/15/11	ISSUED FOR PERMITS
4	01/15/11	ISSUED FOR PERMITS
5	01/15/11	ISSUED FOR PERMITS
6	01/15/11	ISSUED FOR PERMITS
7	01/15/11	ISSUED FOR PERMITS
8	01/15/11	ISSUED FOR PERMITS
9	01/15/11	ISSUED FOR PERMITS
10	01/15/11	ISSUED FOR PERMITS

**REVISIONS**

NO. DATE DESCRIPTION

1 01/15/11 ISSUED FOR PERMITS

2 01/15/11 ISSUED FOR PERMITS

3 01/15/11 ISSUED FOR PERMITS

4 01/15/11 ISSUED FOR PERMITS

5 01/15/11 ISSUED FOR PERMITS

6 01/15/11 ISSUED FOR PERMITS

7 01/15/11 ISSUED FOR PERMITS

8 01/15/11 ISSUED FOR PERMITS

9 01/15/11 ISSUED FOR PERMITS

10 01/15/11 ISSUED FOR PERMITS

**SCALE:** 1/8" = 1'-0"

**DATE:** FEBRUARY 2011

**FILE:** 2009-1300-40A

**1 FIRST FLOOR PLAN**

**A-106**